

DryAway™ Cabinet Design

ECO-FRIENDLY LAUNDRY-DRYING SYSTEM

End Panel

96" H (2440 mm) x 30" D (760mm)

Top Panel

*Inside Width (panel to panel)

4 Frames - 15" ideal inside width (minimum is 14")

6 Frames - 24" ideal inside width (minimum is 21")

8 Frames - 30" ideal inside width (minimum is 28")

A minimum 3/4" solid panel for mounting purposes

Mounting Height

Ideal height from floor to the underside of the ceiling mounting surface (clear height) is 90" (2280mm to 96" (2440mm) but the standard frames will work with a clear height between 88" and 104"

DryAway Dimensions

Depth is 29-1/4" deep and cannot be changed

Mounting hardware has fixed frame spacing with 3-1/4" between centers, frames 20mm thick

Mounting hardware and frame have a total height of 85"

Frame height can be customized for a fee. Can be cut down in 3-1/2" increments starting at 81", 77-1/2", 74"...etc..

Support Cleats

Support the 3/4" solid ceiling panel with cleats on the side panels.

The cleats can be below or above the panel but the panel should be screwed if from above to support (13lbs per frame).

Front Rail Reveal

A maximum of a 3/4" front rail reveal is required to allow the frames to pass by but will hide the mounting hardware for a better finish.

No Cabinet Base

It's recommended not to use a cabinet base to maximize vertical drying space.

No Doors

To guarantee proper drying no doors should be used. Doors only get in the way.

Clothes dry pushed in at full capacity at the same speed as clothes on an accordion rack in the middle of the same room. Just evaporation. No fans needed.

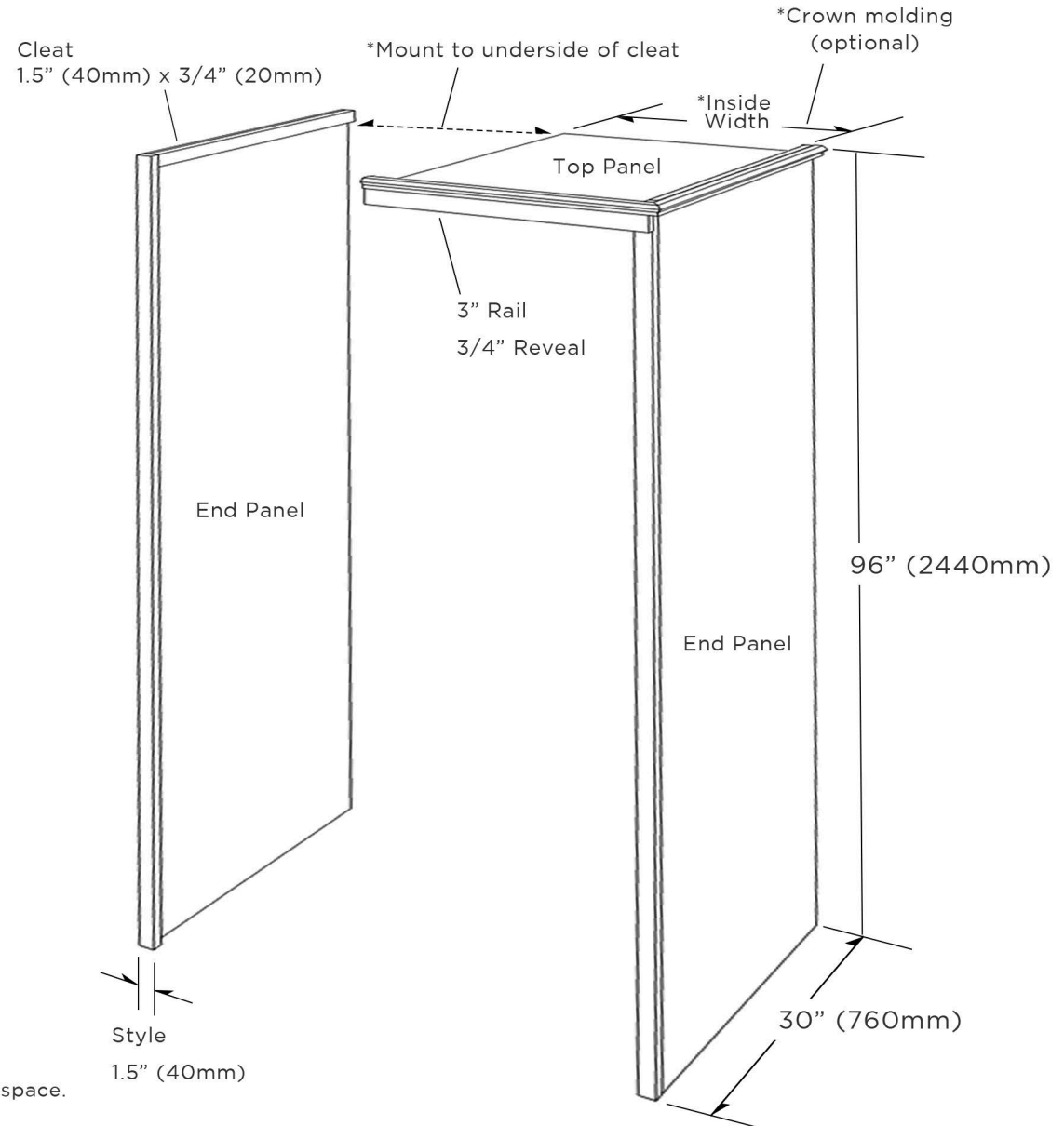

updated 11.14.18